



SHIMANO (EUROPA) GmbH.

Im Hülsefeld 13 4010 Hilden,
West Germany Tel. 02103-5005-0

- You may photocopy this sheet and use it as an order form.
- Sie können dieses Blatt kopieren und als Bestellformular verwenden.
- Vous pouvez photocopier cette feuille et l'utiliser comme bon de commande.
- Dit blad kan gecopieerd en als bestelformulier gebruikt worden.
- Potete fotocopiare questo foglio e usarlo come modulo di commissione.

BR-6400-49

Caliper Brake
SHIMANO 600 Ultegra/49-Type

BR-6400-57

Caliper Brake
SHIMANO 600 Ultegra/57-Type

Standard Pivot Bolt Type

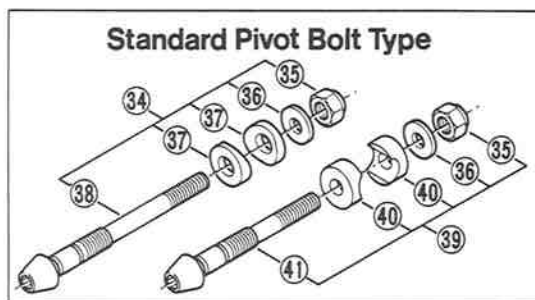

FRONT BRAKE

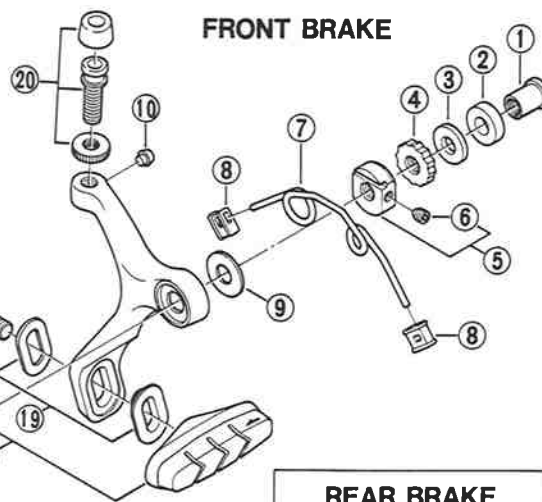

REAR BRAKE

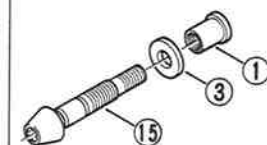

TYPE	A — A'
CS-49	39mm — 49mm
CS-57	47mm — 57mm

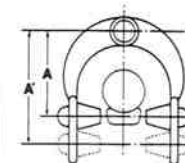

NOTE: "Right" and "Left" as seen from the riding position.

ITEM NO.	PART NO.	DESCRIPTION	Q'TY
1	855 7511	Sunken Pivot Nut	
2	858 5000	Washer for Front (t=4mm)	
3	858 5010	Washer (t=2mm)	
4	857 9812	Lock Nut	
5	83E 9810	Pivot Nut & Stopper Bolt (49-Type)	
	83E 9813	Pivot Nut & Stopper Bolt (57-Type)	
6	884 1400	Stopper Bolt (M4)	
7	83E 0800	Arm Return Spring (49-Type)	
	83E 0810	Arm Return Spring (57-Type)	
8	83E 0900	Sleeve	
9	858 3101	Arm Spacer (t=0.5mm)	
10	83E 1100	Frame Protector for Front Brake Only	
11	83E 2700	Arm Bushing	
12	83E 9809	Pivot Bushing & Washer	
13	82A 0700	Pivot Washer (t=0.8mm)	
14	858 3001	Arm Spacer (t=1mm)	
15	83E 0400	Sunken Pivot Bolt for Front	
	83E 0500	Sunken Pivot Bolt for Rear	
16	870 0700	Cap	
17	—	Brake Shoe Assembly A (Right side for front brake or rear brake)	
18	—	Brake Shoe Assembly B (Left side for front brake or rear brake)	
17&18	83E 9801	Brake Shoe Assembly (4pcs.)	
19	83E 9820	Shoe Fixing Washer & Collar	
20	83F 9802	Cable Adjusting Bolt Unit	
21	83E 9803	Cable Fixing Bolt Assembly w/Quick Release	
22	83E 9807	Quick Lever Fixing Bolt & Washer (M4)	
23	83E 1700	Quick Lever Fixing Bolt (M4)	
24	870 0900	Washer (M4)	
25	83E 1200	Flanged Bush	
26	870 1300	Ball (ø2mm)	
27	83E 9812	Quick Lever	
28	83E 3000	Wave Washer	
29	83E 1500	Cable Fixing Axle	
30	83E 9806	Cable Fixing Bolt & Plate	
31	82A 1800	Cable Fixing Bolt	
32	83E 1600	Cable Fixing Plate	
33	83E 2400	Shoe Fixing Bolt (M6x12)	
*34	83E 9821	Standard Pivot Bolt Unit for Front	
*35	863 2701	Lock Nut for Standard Pivot Bolt Type	
*36	855 1000	Washer for Standard Pivot Bolt Type	
*37	855 2700	Radius Bushing for Front / Standard Pivot Bolt Type	
*38	83E 0410	Standard Pivot Bolt for Front	
*39	83E 9822	Standard Pivot Bolt Unit for Rear	
*40	855 2600	Radius Bushing for Rear / Standard Pivot Bolt Type	
*41	83E 0510	Standard Pivot Bolt for Rear	

BR-6400-49 Caliper Brake SHIMANO 600 Ultegra/49-Type
BR-6400-57 Caliper Brake SHIMANO 600 Ultegra/57-Type

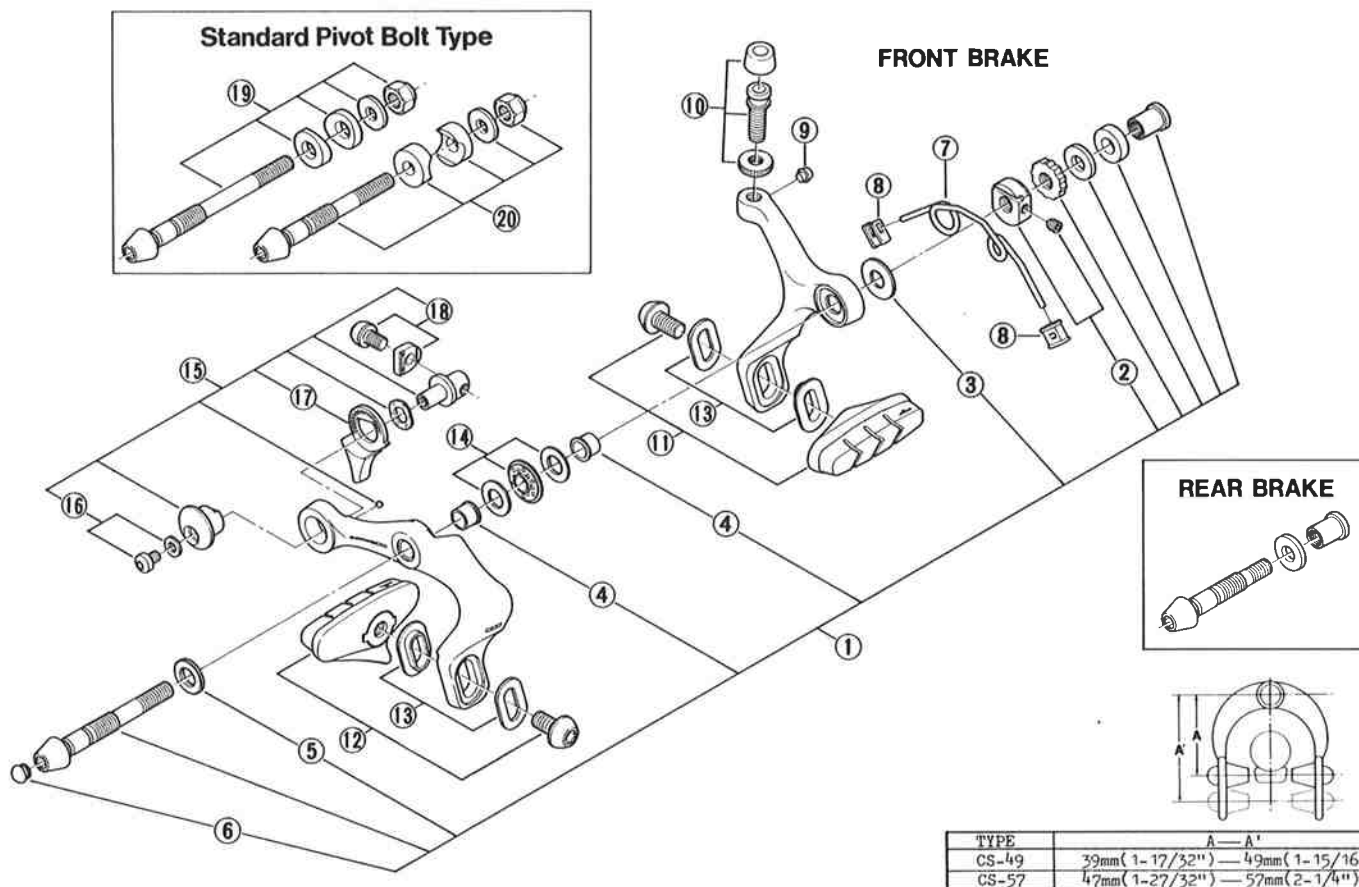

NOTE: "Right" and "Left" as seen from the riding position.

ITEM NO.	PART NO.	DESCRIPTION	Q'TY
* 1	83E 9816	Sunken Pivot Bolt Assembly for Front / 49-Type	
	83E 9814	Sunken Pivot Bolt Assembly for Rear / 49-Type	
2	83E 9810	Pivot Nut & Stopper Bolt (49-Type)	
	83E 9813	Pivot Nut & Stopper Bolt (57-Type)	
3	858 3101	Arm Spacer (t=0.5mm)	
4	83E 2700	Arm Bushing	
5	858 3001	Arm Spacer (t=1mm)	
6	870 0700	Cap	
7	83E 0800	Arm Return Spring (49-Type)	
	83E 0810	Arm Return Spring (57-Type)	
8	83E 0900	Sleeve	
9	83E 1100	Frame Protector for Front Brake Only	
10	83F 9802	Cable Adjusting Bolt Unit	
11		Brake Shoe Assembly A (Right side for front brake or rear brake)	
12		Brake Shoe Assembly B (Left side for front brake or rear brake)	
11&12	83E 9801	Brake Shoe Assembly (4pcs.)	
13	83E 9820	Shoe Fixing Washer & Collar	
14	83E 9809	Pivot Bushing & Washer	
15	83E 9803	Cable Fixing Bolt Assembly w/Quick Release	
16	83E 9807	Quick Lever Fixing Bolt & Washer (M4)	
17	83E 9812	Quick Lever	
18	83E 9806	Cable Fixing Bolt & Plate	
*19	83E 9821	Standard Pivot Bolt Unit for Front	
*20	83E 9822	Standard Pivot Bolt Unit for Rear	