



SHIMANO (EUROPA) GmbH.

Kleinhülsen 1-3 4010 Hilden,
West Germany Tel. 02103-5005-0

SHIMANO AMERICAN CORPORATION

One Shimano Drive, Irvine, California
U.S.A. 92718 Tel. (714) 951-5003

Small parts list for after market.

- You may photocopy this sheet and use it as an order form.
- Sie können dieses Blatt kopieren und als Bestellformular verwenden.
- Vous pouvez photocopier cette feuille et l'utiliser comme bon de commande.
- Dit blad kan gecopieerd en als bestelformulier gebruikt worden.
- Potete fotocopiare questo foglio e usarlo come modulo di commissione.

HB-M550-F Front Hub DEORE LX

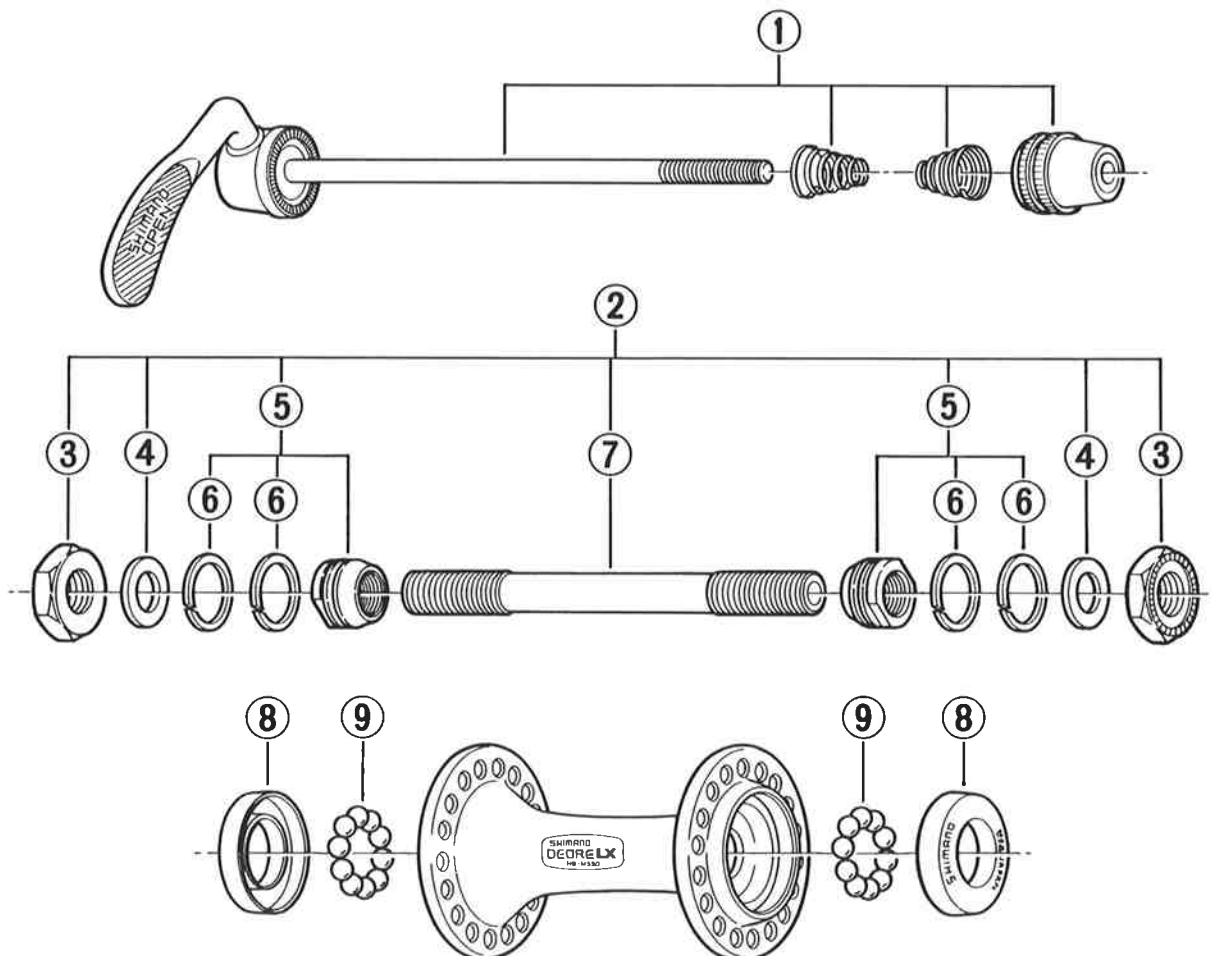

Over Lock Nut Dimension: 100mm(3-15/16")

	Q'TY	ITEM NO.	PART NO.	DESCRIPTION
		1	203 9801	Complete Quick Release 129mm(5-3/32")
		2	338 9803	Complete Hub Axle 108mm(4-1/4")
		3	210 0821-1	Lock Nut 3.5mm
		4	301 0700	Washer 1.5mm
		5	202 9805	Cone (M9x10.5mm) & Seal Ring
		6	236 0300	Seal Ring
		7	338 0400	Hub Axle 108mm(4-1/4")
		8	202 0200-1	Dust Cap
		9	—	Steel Ball (3/16") 10pcs.

Printed in Japan 8908-U1116