

# SHIMANO

**SHIMANO (EUROPA) GmbH.**  
Kleinhülsen 1-3 4010 Hilden, Germany  
Tel. 02103-5005-0

**SHIMANO AMERICAN CORPORATION**  
One Shimano Drive, P.O. Box 19615, Irvine,  
California U.S.A. 92713-9615 Tel. (714) 951-5003

## Small parts list for after market.

- You may photocopy this sheet and use it as an order form.
- *Sie können dieses Blatt kopieren und als Bestellformular verwenden.*
- Vous pouvez photocopier cette feuille et l'utiliser comme bon de commande.
- *Dit blad kan gecopieerd en als bestelformulier gebruikt worden.*
- Potete fotocopiare questo foglio e usarlo come modulo di commissione.

### DURA-ACE Head Parts HP-7410

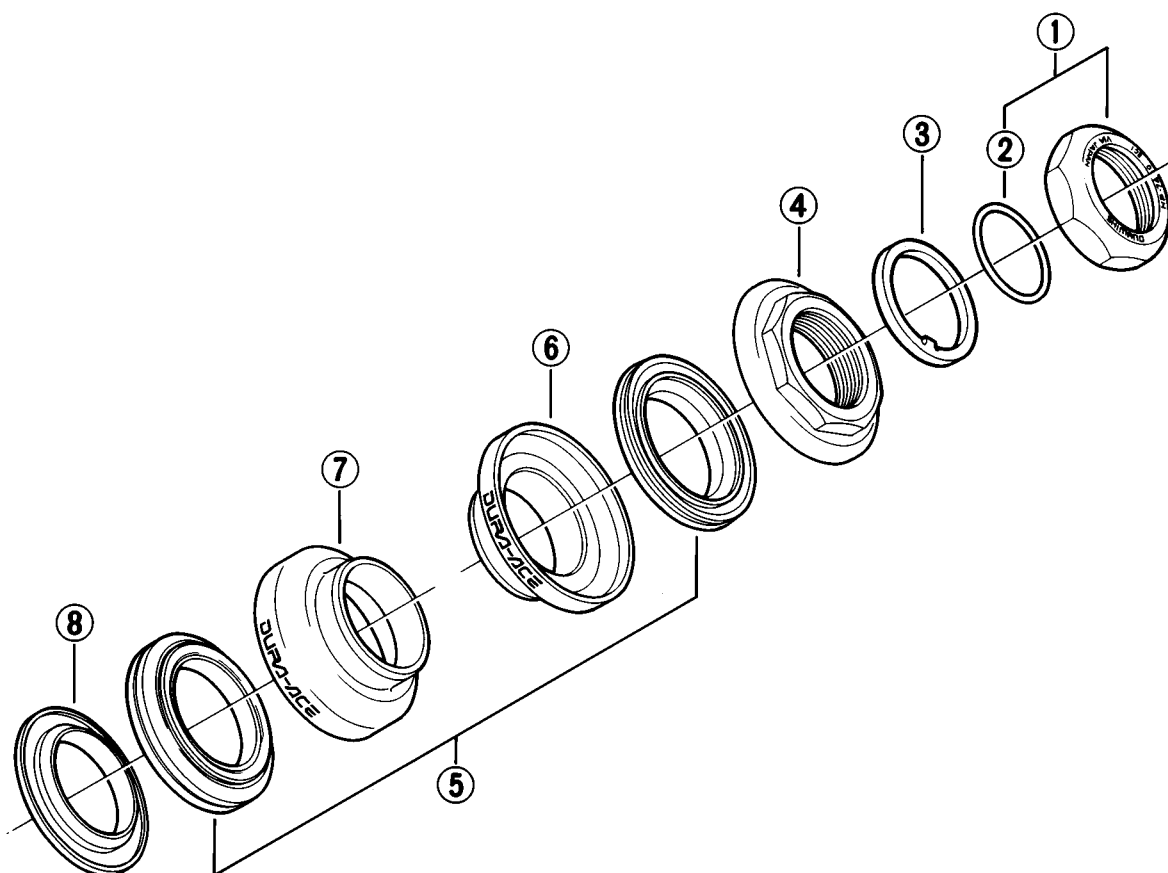

JIS: Japanese Industrial Standards.

Q'TY	ITEM NO.	PART NO.	DESCRIPTION
	1	78A 9801	Lock Nut B.C.1" x 24T (English & JIS Thread) & O-Ring
	2	78A 9802	Lock Nut M25 x P1.0 (French Thread) & O-Ring
	3	727 1200	O-Ring
	4	715 0200	Lock Washer (English & JIS)
	5	715 0210	Lock Washer (French)
	6	78A 0100	Upper Head Cone Housing B.C.1" x 24T (English & JIS Thread)
	7	78A 0110	Upper Head Cone Housing M25 x P1.0 (French Thread)
	8	787 9803	Cartridge Type Bearing (5/32" x 18) 2 pcs.
	9	78A 0210	Upper Head Cup Housing ø30.0mm (JIS)
	10	78A 0200	Upper Head Cup Housing ø30.2mm
	11	78A 0310	Lower Head Cup Housing ø30.0mm (JIS)
	12	78A 0300	Lower Head Cup Housing ø30.2mm
	13	787 0411	Lower Head Cone Housing ø27.0mm (JIS)
	14	787 0401	Lower Head Cone Housing ø26.4mm

010 Printed in Japan 9306-1379